



Society for
NeuroEconomics

NEUROSCIENCE • PSYCHOLOGY • ECONOMICS



21st Annual Meeting

Vancouver, British Columbia, Canada

October 13 – 15, 2023

JW Marriott Parq, Vancouver & the Douglas

neuroeconomics.org |  #SNE2023 | @socforneuroecon

Program at a Glance

Time	Friday		Saturday		Sunday	
	October 13, 2023		October 14, 2023		October 15, 2023	
8:15	Registration / Information Desk Open Posters on Display (Session 1)		Registration / Information Desk Open Posters on Display (Session 2)		Registration / Information Desk Open Posters on Display (Session 3)	
8:30						
8:45		Welcome & Opening Remarks 15 mins (8:45-9:00)				
9:00		Workshop I 60 mins (9:00-10:00) Hendrikje Neinborg		Session II: Social Decision-Making 90 mins (9:00-10:30)		Session III: Risk & Learning 90 mins (9:00-10:30)
9:15						
9:30						
9:45		Workshop II 60 mins (10:00-11:00) Ryan Oprea		Coffee Break 15 mins (10:30-10:45)		Coffee Break 15 mins (10:30-10:45)
10:00						
10:15						
10:30		Coffee Break 15 mins (11:00-11:15)		Speed Networking 60 mins (10:45-11:45)		Session IV: Persuasion, Procastination & Consumer Choice 90 mins (10:45-12:15)
10:45						
11:00						
11:15		Session I: Valuation & Decision-Making 90 mins (11:15-12:45)		Lunch (Included) & Professional Panels 60 mins (11:45-12:45)		Lunch (Included) & Career Path Session Lesley Fellows 60 mins (12:15-13:15)
11:30						
11:45						
12:00		Lunch (Included) & Round Table Session 60 mins (12:45-13:45)		Symposium I 90 mins (12:45-14:15)		Symposium II 90 mins (13:15-14:45)
12:15						
12:30						
12:45		Poster Spotlights I 30 mins (13:45-14:15)		Poster Spotlights II 30 mins (14:15-14:45)		Poster Spotlights III 30 mins (15:00-15:30)
13:00						
13:15						
13:30		Poster Session I 75 mins (14:15-15:30)		Poster Session II 75 mins (14:45-16:00)		Poster Session III 75 mins (15:30-16:45)
13:45						
14:00						
14:15	Off-Site Activity 210 mins (15:30-18:30)	Kavli Plenary Lecture 60 mins (16:00-17:00) Lise Vesterlund	Transition Time 90 mins (17:00-18:30)			
14:30						
14:45						
15:00						
15:15						
15:30						
15:45						
16:00						
16:15						
16:30						
16:45						
17:00						
17:15						
17:30						
17:45						
18:00						
18:15						
18:30						
18:45						
19:00	Pub Meet Up	Conference Dinner				
19:15						
19:30						
19:45						
20:00						

Table of Contents

PROGRAM AT A GLANCE1

ABOUT THE SNE SOCIETY3

WELCOME FROM THE PRESIDENT4

GENERAL MEETING INFORMATION5

VENUE MAP.7

SPEAKERS8

DETAILED PROGRAM10

POSTER SESSIONS16

 POSTER SESSION 116

 POSTER SESSION 218

 POSTER SESSION 320

POSTER AUTHOR INDEX23

SPONSORS27

About the SNE Society

OUR MISSION

The mission of the Society for Neuroeconomics is to:

1. **Foster research on the foundations of economic behavior by promoting collaboration and discussion among scholars from the psychological, economic, and neural sciences.**
2. **Ensure the continued advancement of the field of neuroeconomics by supporting young researchers.**

The Society promotes this mission through annual meetings for presentation of original theory and research, and through educational programs to promote development of a common language and set of methodological tools for the field.

BOARD OF DIRECTORS

Officers

President

Agnieszka Tymula, *University of Sydney*

President Elect

Tali Sharot, *University College London*

Secretary/Treasurer

Robb Rutledge, *University College London*

Immediate Past President

Lesley Fellows, *McGill University*

Board Members

Oriel FeldmanHall, *Brown University*

Paul Glimcher, *New York University*

Ming Hsu, *University of California, Berkeley*

Cendri Hutcherson, *University of Toronto*

Ian Krajbich, *Ohio State University*

Karolina Lempert, *Adelphi University*

Patricia Lockwood, *University of Birmingham*

Nicolette Sullivan, *London School of Economics*

Ryan Webb, *University of Toronto*

Conference Chairs

Paul Glimcher, *New York University*

Oriel FeldmanHall, *Brown University*

Podium Conference Specialists

Vivek Punwani

Gail McHardy

Sebastien Lavoie

COMMITTEES

Nominations Committee

Lesley Fellows, *McGill University*

Tali Sharot, *University College London*

Agnieszka Tymula, *University of Sydney*

Program Committee

Gökhan Aydogan, *University of Zurich*

Giorgio Coricelli, *University of Southern California*

Oriel FeldmanHall, *Brown University*

Lesley Fellows, *McGill University*

Paul Glimcher, *New York University*

Sebastian Gluth, *University of Hamburg*

Cendri Hutcherson, *University of Toronto*

Uma Karmarkar, *University of California, San Diego*

Arkady Konovalov, *University of Birmingham*

Camelia Kuhnen, *University of North Carolina, Chapel Hill*

Dino Levy, *Tel Aviv University*

Ifat Levy, *Yale University*

Jian Li, *Peking University*

Silvia Lopez-Guzman, *National Institutes of Health*

Kenway Louie, *New York University*

Suzanne Mitchell, *Oregon Health & Science University*

Tom Schonberg, *Tel Aviv University*

Amitai Shenhav, *Brown University*

Alireza Soltani, *Dartmouth College*

Nicolette Sullivan, *London School of Economics and Political Science*

Philippe Tobler, *University of Zurich*

Anita Tusche, *Queen's University*

Iris M Vilares, *University of Minnesota, Twin Cities*

Jan Zimmermann, *University of Minnesota*

Welcome from the President

Dear Colleagues,

I am delighted to extend a warm welcome to all of you, both seasoned SNE conference veterans and those for whom this is your first SNE conference experience, as we gather for the 2023 Annual Conference of the Society for Neuroeconomics in the stunning city of Vancouver, British Columbia, Canada. On behalf of the entire organizing committee, it is my privilege to invite you to immerse yourselves in an intellectually stimulating experience over the next three days.

Neuroeconomics, at the intersection of economics, neuroscience, and psychology, has witnessed remarkable growth in recent years. This year's conference promises to be a platform for sharing cutting-edge research, fostering collaborations, and expanding our collective understanding of the intricate neural mechanisms that underpin economic decision-making. I am thrilled to announce that we have the honor of hosting Professor Lise Vesterlund as our distinguished Kavli Plenary Speaker for this conference. Professor Vesterlund's pioneering work in experimental economics has significantly advanced our understanding of gender differences in economic behavior, social preferences, and decision-making. Her contributions to the field have been both groundbreaking and inspirational, and we eagerly anticipate her plenary address, which promises to be a highlight of our conference program. In addition, we are pleased to offer two workshops presented by two distinguished experts: Dr. Hendrikje Nienborg and Prof. Ryan Oprea.



In addition to the enriching scientific program, we invite you to explore the city of Vancouver and take advantage of the diverse social activities we have arranged that include walking, biking, Halloween activities, visiting galleries, Granville Island Public Market, and a thrilling FlyOver Canada. These activities are an excellent opportunity to unwind, network with fellow attendees, and experience the rich culture and natural wonders of Vancouver.

I would like to extend my heartfelt appreciation to our sponsors, volunteers, and the dedicated members of the program committee who have worked tirelessly to ensure the success of this event.

I encourage you all to actively participate, ask questions, and engage in discussions throughout the conference and workshops. Your contributions are what make this gathering exceptional, and I am confident that your insights will inspire future research and innovation in neuroeconomics. I hope that the 2023 Annual Conference of the Society for Neuroeconomics will be a memorable and intellectually rewarding experience for each and every one of you.

Thank you for being a part of this vibrant community, and I look forward to engaging with you all during the conference.

Warm regards,

Agnieszka Tymula

President, Society for NeuroEconomics

General Information

MEETING VENUE

JW Marriott Parq, Vancouver & the Douglas
located at 39 Smithe Street, Vancouver, BC, V6B 0R3.

VENUE WI-FI ACCESS

Complimentary wireless internet is available to the delegates of the Society of NeuroEconomics Annual Meeting. Please note the complimentary WiFi is ideal for checking emails and websites but is not strong enough for streaming videos or heavy social media use.

Network name: JW_Marriott_Conference

Password: SNE23

REGISTRATION

The annual meeting of the Society for NeuroEconomics registration includes access to entire conference program (plenary sessions, symposia sessions, individual oral sessions, dedicated poster sessions, and special interest sessions), complimentary Wi-Fi in the congress space, digital program, mobile app and the opportunity to network with colleagues, collaborators and others professional development opportunities and the 14th Annual Fred Kavli Lecture.

MEALS & DIETARY REQUIREMENTS

Your conference registration includes a daily coffee break, and lunch as well as the final conference dinner on Saturday, October 14th, 2023. All food & beverage served at breaks and the opening reception will be marked clearly. We have made every effort to select a variety of items to ensure inclusivity in what is provided.

NAME BADGES

Your name badge is your admission ticket to all conference sessions, coffee breaks, lunches, and the pub-meet up on Friday, October 13th, 2023. **Please wear it at all times.** At the end of the conference, we ask that you recycle your name badge in one of the name badge recycling stations that will be set out or leave it at the registration desk.

LOST NAME BADGES

There is a \$25 replacement fee for any lost or missing name badges – If you've lost your name badge, visit the registration desk for a replacement as soon as possible.

REGISTRATION AND INFORMATION DESK HOURS

The SNE registration and information desk, located in the Parq Grand Ballroom Foyer, will be open during the following dates and times:

Friday, October 13 8:00–16:00

Saturday, October 14 8:30–17:30

Sunday, October 15 8:30–17:00

If you need assistance during the conference, please visit the registration desk, or “Ask the Organizer” in the Whova mobile app.

POSTER SESSIONS

Poster Session 1: Friday, October 13, 2023

Set Up: Before 13:45

Session Time: 14:15 – 15:30

Tear Down: Please tear down by 18:00

Poster Session 2: Saturday, October 14, 2023

Set Up: Before 14:15

Session Time: 14:45 – 16:00

Tear Down: Please tear down by 18:00

Poster Session 3: Sunday, October 15, 2023

Set Up: Before 15:00

Session Time: 15:30 – 16:45

Tear Down: Please tear down by 17:15

Any posters that are not taken down by the removal deadline will be held at the registration desk until the end of the conference. Any posters that remain unclaimed by the end of the conference will be disposed of. Information on Poster Authors, Poster Numbers and Poster Titles begins on **page 17**.

STAFF

SNE staff from Podium Conference Specialists can be identified by bright orange **STAFF** ribbons on their name badges. Feel free to ask anyone of our staff for assistance. For immediate assistance please visit us at the registration desk.

OFF-SITE ACTIVITIES

[Vancouver Bike Rentals](#)

We have hundreds of rental bikes in Vancouver, from city cruisers & e-bikes for comfort to performance road bikes for the more experienced rider. All bike rentals include complimentary helmet, lock, basket or handlebar bag & a map. Book online to guarantee your bike (and save 10%), or walk-in to browse our selection — we always keep some bikes available for walk-in rentals.

[Walk along the Seawall and Stanley Park](#)

This will be a self-guided walking tour that will give you the opportunity to walk along the famous Vancouver Seawall and Stanley Park.

[Capilano Suspension Bridge - Halloween Tour](#)

Looking for Halloween activities in Vancouver? Look no further! Wander through Capilano Suspension Bridge Park's Canyon Frights—if you dare! Grab your friends, family and your costumes for a few tricks and treats and a whole lot of family fun!

[Granville Island Public Market](#)

As Vancouver's premier artistic and cultural hub, located in an urban, waterfront location and steeped in a rich industrial and maritime heritage, this unique destination attracts millions of visitors each year from Vancouver and around the world. The charm of Granville Island lies in its unexpected mix of uses. The famous Public Market, open daily from 9am to 7pm, is home to more than 50 independent food purveyors and contributes to the Island's appeal as a renowned culinary destination. In the Net Loft Shops and in the Artisan District, many of Canada's best artists and designers can be found. Granville Island is home to many cultural venues and hosts numerous performing arts and cultural festivals year-round. Operationally self-sustaining, Granville Island is home to more than 300 businesses employing more than 3,000 people.

[Fly Over Canada Virtual Experience](#)

Welcome to FlyOver Canada — home of North America's leading flying ride. Using advanced technology, we capture thrilling, authentic footage of real locations so riders can experience those places as they truly are. Located in downtown Vancouver's Canada Place, FlyOver Canada whisks you away on an exhilarating journey over the world's most spectacular scenery. Special effects — including wind, mist and scents — combine with the ride's motion to create an unforgettable experience.

[Vancouver Art Gallery](#)

Founded in 1931 and located on the unceded territories of the xwməθkwəyəm (Musqueam), Skwxwú7mesh (Squamish) and səílwlətaʔ (Tsleil-Waututh) nations, the Vancouver Art Gallery is Western Canada's largest public art museum. Our mission is to create—through art—paths to share perspectives, build and engage communities and shape our collective future together. This is expressed through exhibitions showcasing historical and contemporary art from BC and around the world; education programs that encourage dialogue and understanding; and publications that advance scholarship on a wide range of artistic subjects. Our permanent collection, representing the most comprehensive resource for visual culture in BC, has more than 12,600 works. We regularly feature highlights from our collection in temporary thematic exhibitions.

Venue Map

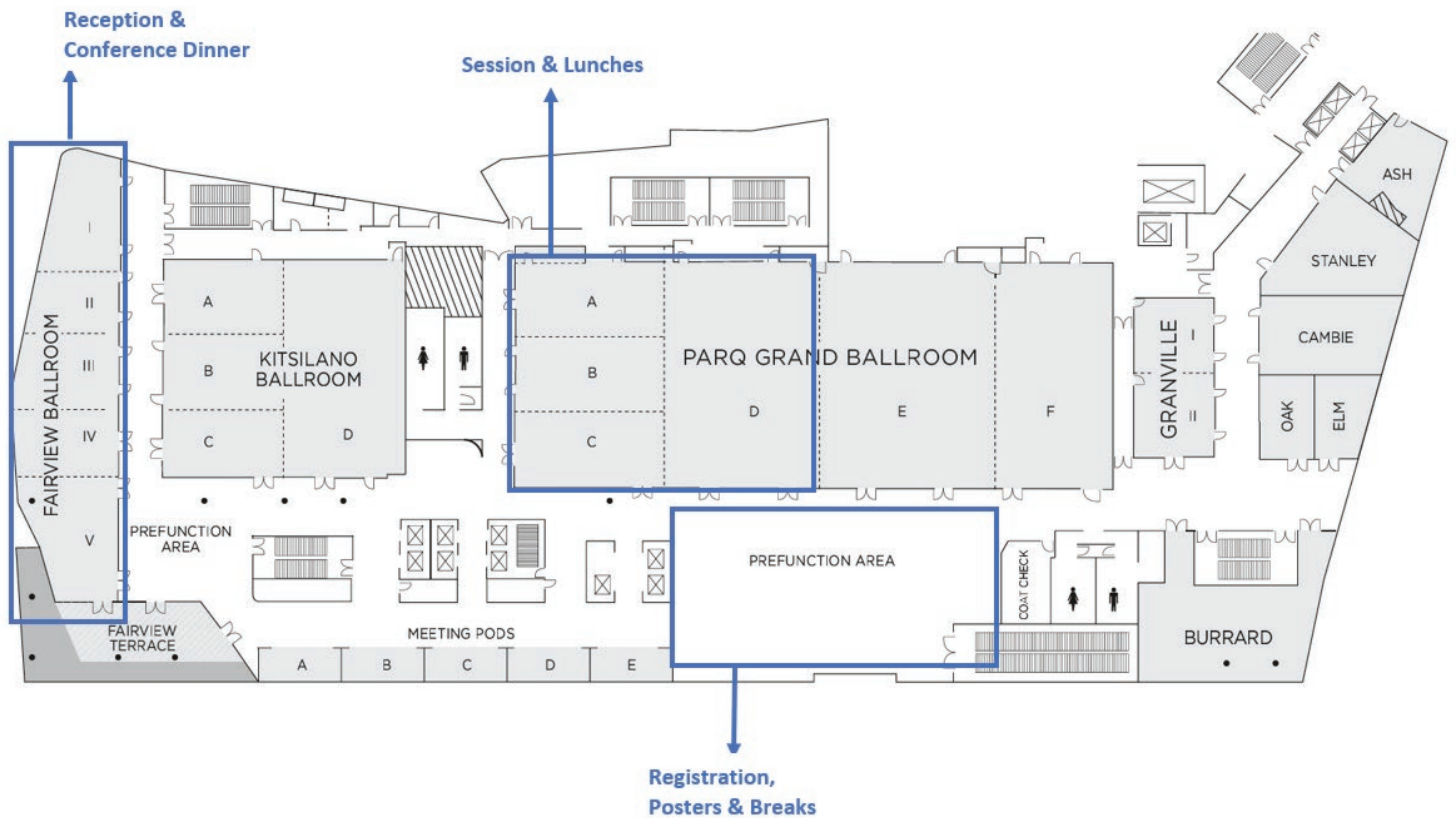

Speakers

KAVLI LECTURE SPEAKER



Lise Vesterlund

Lise Vesterlund is the Andrew W. Mellon Professor of the Department of Economics at the University of Pittsburgh and the Director of the Pittsburgh Experimental Economics Laboratory (PEEL) and of the Behavioral Economic Design Initiative (BEDI). She is a Research Associate with the National Bureau of Economic Research. A co-author of the book, "The No Club: Putting a Stop to Women's Dead-End Work," her highly influential research on gender differences in advancement has been featured by The New York Times, The Guardian, Wall Street Journal, The Washington Post, The Economist, and The Financial Times.

WORKSHOP SPEAKERS



Hendrikje Nienborg

Hendrikje Nienborg is an investigator and NIH Distinguished Scholar at the National Eye Institute, NIH, USA, where she leads the Section on Visual Decision Making. She received her medical and doctoral degrees from the Ludwig-Maximilians University in Munich, Germany, and a Master in Neuroscience from the University of Oxford, UK. She conducted postdoctoral work at the National Eye Institute and at the Salk Institute for Biological Studies in La Jolla, CA, before heading her own research group first at the University of Tuebingen, Germany, and since 2019 at the National Eye Institute. Her research has received funding from the NEI (K99/R00 award), the Kavli foundation, the European Research Council (ERC) and the German Research Foundation (DFG). Her lab uses computational, behavioral, pharmacological, functional imaging, large-scale electrophysiological, and, through collaboration, machine learning approaches to address the following questions: 1) how are cognitive and sensory signals integrated in the brain during visually guided decisions? 2) how do context, such as motivation, behavioral state or learning, influence the encoding of the incoming sensory signals? 3) how are these combined signals used when we make decisions? Her group aims to help answer these questions in healthy mammalian brains.



Ryan Oprea

Ryan Oprea is the Maxwell C. and Mary Pellish Chair of Economics at the University of California, Santa Barbara. His research is focused on understanding how complexity and bounded rationality influence human behavior and institutions. Ryan serves on the editorial board of the American Economic Review, the Review of Economics and Statistics and Experimental Economics. He also serves on the executive committee for the Sage Center for the Study of the Mind and the Foundations Institute. Previously he served as the director of the Laboratory for the Integration of Theory and Experiments (LITE) at UCSB, on the executive committee of the Economic Science Association and as an associate editor at Games and Economic Behavior. He is a two time recipient of the Exeter Prize for the best paper published Experimental Economics, Behavioral Economics and Decision Theory.

10th Consumer Neuroscience Satellite Symposium

Sage Restaurant,
UBC University of British Columbia
Vancouver, Canada

Thursday, October 12, 2023
11:30am – 7:30pm



Keynote Speakers:

Julian De Freitas, *Harvard Business School*

Emily Falk, *University of Pennsylvania*

Brian Knutson, *Stanford University*

Organizers:

Dale Griffin, *University of British Columbia*

Felix Jan Nitsch, *INSEAD*

Hilke Plassmann, *INSEAD*

Carolyn Yoon, *University of Michigan*

The purpose of the symposium is to take stock of the current knowledge at the intersection of business school research and neuroscience, provide ideas for future research, and allow interested researchers to meet and discuss research ideas.

Environmental, social, and corporate governance

UBC SAUDER
SCHOOL OF BUSINESS



The Business School
for the World®



Detailed Program

FRIDAY, OCTOBER 13

08:45-09:00 Welcome & Opening Remarks

- Agnieszka Tymula, *University of Sydney* | SNE President
- Paul Glimcher, *New York University*
- Oriel FeldmanHall, *Brown University*

09:00-10:00 **Workshop I** Perceptual Decisions as Action-perception Loops in Neural Circuits Hendrikje Nienborg, *National Institutes of Health*

10:00-11:00 **Workshop II** Simplicity Equivalents Ryan Oprea, *University of California, Santa Barbara*

11:00-11:15 Coffee Break

11:15-12:45 **Oral Session I** Valuation & Decision-Making

Chair: Karolina Lempert, *University of Pennsylvania*

01.1: Attentional Discounting in Gains, Attentional Amplification in Losses

Brenden Eum¹, Stephen Gonzalez², Antonio Rangel¹

¹California Institute of Technology, ²Stanford University

01.2: Pre-acquired functional connectivity predicts choice inconsistency

Asaf Madar¹, Vered Kurtz-David², Adam Hakim¹, Dino Levy¹, Ido Tavor¹

¹Tel Aviv University, ²New York University

01.3: A Grid-like Code for Value-Based Decision Making

Mark Orloff¹, Seongmin Park¹, Jake Blumwald¹, Philippe Domenech², Erie Boorman¹

¹University of California, Davis, ²University of Manitoba

01.4: Neural mechanisms underlying the prospective estimation of self-control costs

Candace Raio¹, Lewis Leone¹, Anna Konova², Paul Glimcher¹

¹New York University, ²Rutgers University

12:45-13:45 **Lunch & Round Table Session**

Location: Parq ABC

- Natalia Velez Alicia: Machine learning, reinforcement, and AI
- Cendri Hutcherson: Neuroscience of social decision making and morality
- Carolyn Yoon: Consumer neuroscience and marketing
- Marc-Lluis Vives & Silvia Lopez-Guzman: Getting an academic job (led by recent hires)

12:45-13:45 **Lunch**

13:45-14:15

Poster Spotlights I

Chair: **Tobias Kalenscher**, *Heinrich Heine University Düsseldorf*

P1-E-16: Pain now! Exploring the relationship between pain, temporal uncertainty, and intertemporal choices

Mathieu Roy¹, Taryn Berman¹

¹*McGill University*

P1-E-17: "Will" it be Seen? Using Eye Tracking to Re-examine the Future Tense Effect in Intertemporal Choices

Josie Chen¹, Wei Chen², Jiang-Shiang Hu¹

¹*Nanyang Technological University*, ²*National Taiwan University*

P1-E-18: Understanding the mechanism of perceived control: the role of self-efficacy and response efficacy

Yun-Yen Yang¹, Mauricio Delgado¹

¹*Rutgers University - Newark*

P1-K-41: Attentional mechanisms underlying cooperative behavior

Claire Lugin¹, Arkady Konovalov², Christian Ruff¹

¹*University of Zürich*, ²*University of Birmingham*

14:15-15:30

Poster Session 1

A full **abstract book** can be found on SNE's [Program page](#).

Sponsored by:



THE UNIVERSITY OF
SYDNEY

15:30-18:30

Off-Site Activities

Please select your preferred off-site activity on the conference registration form. You will be contacted with more details on how to book your activity from your group leader in mid-September.

Activities include:

- Vancouver Bike Rentals
- Capilano Suspension Bridge - Halloween Tour
- Granville Island Public Market
- Fly Over Canada Virtual Experience
- Vancouver Art Gallery
- Walk along the Seawall
- Stanley Park

18:30-22:00

Pub Meet Up

Location: The Portside Pub, Upper Lounge
7 Alexander Street, Vancouver BC, V6A 1E9

SATURDAY, OCTOBER 14

9:00-10:30

Oral Session II Social Decision-Making

Chair: **Uma Karmarkar**, *Rady School of Management UCSD*

O2.1: Neural asymmetry in aligning with generous versus selfish descriptive norms in a charitable donation task

Paloma Diaz-Gutierrez¹, Christophe Boone², Harshil Vyas², Carolyn Declerck²

¹Universiteit Antwerpen, ²University of Antwerp

O2.2: Neural predictors of interpersonal trust across cultures

Huan Wang¹, Brian Knutson¹, Jeanne Tsai¹

¹Stanford University

O2.3: The neural mechanism of social preference changes across joint versus separate evaluation

Yinmei Ni¹, Jian Li¹

¹Peking University

O2.4: Stable patterns of ongoing self-generated thoughts predict variance in generosity across people and contexts

Lisa Bas¹, Ruien Wang¹, Yijun Xu¹, Anita Tusche¹

¹Queen's University

10:30-10:45

Coffee Break

10:45-11:45

Speed Networking

Location: Parq ABC

Requires advance sign-up on the registration form.

Join us on Oct. 14 in the hour before lunch, when trainees will have a chance to chat with faculty/PIs in a fun and informal setting.

11:45-12:45

Lunch & Professional Panels

Enjoy your included lunch while enjoying one of our two Professional Panel sessions.

Panel I: Managing Labs

Chair: *Hilke Plassmann, INSEAD*

- Agnieszka Tymula, *University of Sydney*
- Tobias Kalenscher, *Heinrich Heine University Düsseldorf*
- Brian Knutson, *Stanford University*

Panel II: JEDI in Practice

Location: Parq ABC

Chairs: *Paul Glimcher, New York University*

Oriel FeldmanHall, Brown University

- Lise Vesterlund, *University of Pittsburgh*

12:45-14:15

Symposia I Information sampling and integration: Insights from rodents, monkeys and humans

Chair: **Laura Globig**, *University College London*

S1.1: A common cause for multiple suboptimalities in evidence accumulation

Diksha Gupta¹, Brian Depasquale², Charles Kopec³, Carlos Brody³

¹University College London, ²Boston University, ³Princeton University

S1.2: Integrating information and reward into subjective value: humans, monkeys, and the lateral habenula

Ethan Bromberg-Martin¹, Yang-Yang Feng², Takaya Ogasawara², J. Kael White², Kaining Zhang², Ilya Monosov²
¹Washington University School of Medicine, ²Washington University

S1.3: How Multifaceted Motives impact Evidence Accumulation

Laura Globig¹, Tali Sharot¹
¹University College London

S1.4: The informational cost and utility of expressing emotions: a computational model of social signalling

Yi Yang Teoh¹, Cendri Hutcherson¹
¹University of Toronto

14:15-14:45

Poster Spotlights II

Chair: **Robb Rutledge**, Yale

P2-D-9: The Effect of Acute Stress on Humanitarian Supplies Management

Maximilian Burkhardt¹, Felix Nitsch², Stefan Spinler¹, Luk Van Wassenhove²
¹WHU Otto Beisheim School of Management, ²INSEAD Business School

P2-D-10: Trial-to-trial fluctuations in risk preference originate from Bayesian inference on noisy neural representations

Gilles De Hollander¹, Marcus Grueschow¹, Christian Ruff¹
¹University of Zürich

P2-D-11: The Processing of Negative Numbers and its Impact on Subjective Valuation

Hannah Seidler¹, Sebastian Olschewski², Benjamin Scheibehenne¹
¹Karlsruhe Institute of Technology, ²University of Basel & Warwick Business School

P2-H-26: The impact of presentation order and response labeling on the reward learning of task representations

Mina Habibi¹, Mehdi Senoussi², Pieter Verbeke¹, Senne Braem¹
¹Ghent University, ²Université de Toulouse

P2-I-34: Individual differences in effort-based decision-making: dorsomedial prefrontal cortex metabolic and fMRI underpinnings

Nicolas Clairis¹, Arthur Barakat¹, Carmen Sandi¹
¹Behavioral Genetics Laboratory (LGC)

14:45-16:00

Poster Session 2

A full **abstract book** can be found on SNE's [Program page](#)

Sponsored by:



16:00-17:00

14th Annual Fred Kavli Plenary Lecture

Gendered Work Assignments: Cause and Consequence
Lise Vesterlund, University of Pittsburgh

Sponsored by:



All organizations have work that no one wants to do: planning the office party, screening interns, attending to that time-consuming client, or simply helping others with their work. From office housework to important assignments that inevitably go unrewarded, a woman, most often, takes on these tasks. The talk will present research on the source and consequences of these differences, and will discuss the small, yet significant, changes that can help women and their organizations reach their potential.

19:00-22:00

Conference Dinner

Location: Fairview Ballroom

SUNDAY, OCTOBER 15

09:00-10:30

Oral Session III Risk & Learning

Chair: **Robb Rutledge**, *Yale*

03.1: Ambiguity aversion arises from nonlinear forward sampling of future reward states

Kenway Louie¹

¹New York University

03.2: Adaptive generalization and efficient learning under uncertainty

Jiwon Park¹, Dongil Chung¹

¹Ulsan National Institute of Science and Technology

03.3: Representations of information value in mouse orbitofrontal cortex during information seeking

Jennifer Bussell¹, Ethan Bromberg-Martin², Ryan Badman³, Kanaka Rajan³, Larry Abbott¹, Richard Axel⁴

¹Columbia University, ²Washington University School of Medicine, ³Icahn School of Medicine,

⁴Columbia University & Howard Hughes Medical Institute

03.4: An Interplay of Nucleus Accumbens and Anterior Insula Activity Predicts Risky Choice

Leili Mortazavi¹, Charlene Wu¹, Elnaz Ghasemi¹, Brian Knutson¹

¹Stanford University

10:30-10:4

Coffee Break

10:45-12:15

Oral Session IV Persuasion, Procrastination & Consumer Choice

Chair: **Tobias Kalenscher**, *Heinrich Heine University Düsseldorf*

04.1: The Dynamic Nature of Procrastination

Peiyuan Zhang¹, Wei Ji Ma¹, Yijun Lin², Falk Lieder³

¹New York University, ²University of Florida, ³Max Planck Institute for Intelligent Systems

04.2: Social media users' posting behavior can be as-if addictive

Felix Nitsch¹, Klaus Wertenbroch¹, Hilke Plassmann¹

¹INSEAD Business School

04.3: Neural mechanisms underlying the persuasion by healthy eating calls

Ioannis Ntoumanis¹, Alina Davydova¹, Yulia Sheronova¹, Vladimir Kosonogov¹, Ksenia Panidi²,

Anna Shestakova¹, Iiro Jääskeläinen¹, Vasiliy Kliucharev³

¹HSE University, ²Higher School of Economics, ³Higher School of Economics - National Research University

04.4: Why do storytelling ads persuade consumers? Evidence from brain responses to video commercials

Leo Van Brussel¹, Maarten Boksem¹, Ale Smidts²

¹Erasmus University Rotterdam, ²Erasmus University

12:15-13:15

Lunch & Career Path Session

Location: Parq ABC

Join us for an informal discussion on the career journey of Dr. Lesley Fellows. Lunch included.

Chair: Paul Glimcher, *New York University*

■ Lesley Fellows, *McGill University*

12:15-13:15

Lunch

13:20-14:50

Symposia II Beyond the Matrix: Experimental Approaches to Studying Social-Ecological Systems

Chair: **Uri Hertz**, *University of Haifa*

S2.1: Beyond the Matrix: Experimental Approaches to Studying Social-Ecological Systems

Joel Leibo¹, Raphael Koster¹, Marco Janssen², Uri Hertz³

¹Google DeepMind, ²Arizona State University, ³University of Haifa

S2.2: Conditions for cooperation in Social-Ecological Systems

Marco Janssen¹

¹Arizona State University

S2.3: Studying large-scale collaborations in online communities

Natalia Vélez¹

¹Princeton University

S2. 4: Learning how to behave: cognitive learning processes underlying adaptation to social norms and intergroup bias

Uri Hertz¹

¹University of Haifa

15:00-15:30

Poster Spotlights III

Chair: **A. David Redish**, *University of Minnesota*

P3-I-32: Redefining Attribute Weighting in Food and Social Choices: Evidence for Non-linear Models

Dongqi (Sherry) Bao¹, Gaia Lombardi¹, Da Li¹, Carolina Feher Da Silva², Todd Hare¹

¹University of Zürich, ²University of Surrey

P3-I-33: Competition between stimulus- and action-based learning strategies accounts for monkeys' behavior during dynamic learning

Jae Hyung Woo¹, Kathryn Rothenhoefer², Ken-Ichiro Tsutsui³, Fabian Grabenhorst⁴, Vincent Costa², Wolfram Schultz⁵, Alireza Soltani¹

¹Dartmouth College, ²Oregon Health & Science University, ³Tohoku University, ⁴University of Oxford, ⁵University of Cambridge

P3-L-44: Effect of transcranial direct current stimulation (tDCS) on FRN and P2 during the performance of auditory monetary incentive delay task

Anastasia Grigoreva¹, Aleksei Gorin¹, Valeriy Klyuchnikov¹, Anna Shestakova¹

¹HSE University

P3-L-45: Designing a sustainable economy with deep reinforcement learning

Raphael Koster¹

¹Google DeepMind

15:30-16:45

Poster Session 03

A full **abstract book** can be found on SNE's [Program page](#)

Sponsored by:



Poster Sessions

ABOUT THE POSTER SESSION

The Society for NeuroEconomics is pleased to present a wide range of current research through the poster sessions. The posters have been divided over three sessions, with each session on display for one day.

Session 1: **Friday, October 13, 2023**
14:15 - 15:30

Session 2: **Saturday, October 14, 2023**
14:45 - 16:00

Session 3: **Sunday, October 15, 2023**
15:30 - 16:45

The poster board numbers work in the following way:
Poster Session – Theme – Board Number (ex. P1-A-1)

POSTER THEMES

- A** Finance
- B** Consumer Behavior & Marketing
- C** Game Theory & Strategic Interactions
- D** Risk & Uncertainty
- E** Intertemporal Decision-Making & Self-Control
- F** Social Behaviour
- G** Individual & Lifespan Differences
- H** Learning & Memory
- I** Valuation & Decision Making
- J** Emotion
- K** Attention
- L** Methodological Development

Poster Session 1

FRIDAY, OCTOBER 13

P1-B-1 Individual Differences in Autistic Traits Affect Visual Engagement with Advertisements

Andrea Bazzani¹, Davide Benedetti², Paolo Frumento², Liliana Dell'osso², Giuseppe Turchetti¹, Ugo Faraguna²
¹Sant'Anna School of Advanced Studies, ²University of Pisa

P1-B-2 Source Memory Is More Accurate for Opinions Than for Facts

Daniel Mirny^{1,2}, Stephen Spiller³
¹IESE Business School, ²University of California, Los Angeles

P1-B-3 The effect of commercials on the neural signal of value

Inbal Gur Arie¹, Adam Hakim¹, Valentina Parada, Dino Levy¹
¹Tel Aviv University

P1-B-4 Brain responses to vehicles predict individual interest and forecast changes in aggregate demand

Dylan Christiano¹, Tara Srirangarajan², Shabnam Hakimi³, Matthew Klenk³, Monica Van³, Charlene Wu², Kalani Murakami³, Brian Knutson²
¹Stanford University & University of Michigan, ²Stanford University, ³Toyota Research Institute

P1-B-5 Structural Properties of Association Networks Predict Preference-Based Set Choice

Kianté Fernandez¹, Uma Karmarkar², Ian Krajbich¹
¹University of California, Los Angeles, ²University of California, San Diego

P1-C-6 Available Cognitive Resources Shape Subjects' Sophistication in Games

Vered Kurtz-David¹, Adam Brandenburger¹, Paul Glimcher¹
¹New York University

P1-C-7 The Effects of Arbitrary Social Comparison on Trust and Risky Decision Making

Shulang Yue¹, Iris M Vilares¹
¹University of Minnesota, Twin Cities

P1-C-8 The single- and dual-brain mechanisms underlying the adviser's confidence expression strategy switching during influence management

Shuyi Zha

P1-C-9 How do adolescents sustain cooperation with peers versus highly adaptive computer partners?

Wenda Liu¹, Isabella Mark¹, Christoph W. Korn², Gabriela Rosenblau¹
¹George Washington University, ²Heidelberg University

P1-D-11 Predicting Entrepreneurial Status: Insights from Gray Matter Volume and Brain Responses to Uncertainty

Tom Lahti¹, Kaisa Hytönen², Joakim Wincent¹, Iiro Jääskeläinen³, Martin Schürmann⁴, Marja-Liisa Halko⁵
¹Hanken School of Economics, ²Laurea University of Applied Sciences, ³Aalto University School of Science, ⁴University of Nottingham, ⁵University of Helsinki

P1-D-12 Acute stress induces risk-seeking via more optimistic beliefs

Gilles De Hollander¹, Maike Renkert¹, Saurabh Bedi¹, Gökhan Aydogan¹, Christian Ruff¹
¹University of Zürich

P1-D-13 Utility function changes with the gamble's winning probability

Yilong Lu¹, Yang-Fan Lu¹, Hang Zhang¹
¹Peking University

P1-D-14 Survey and Incentive-Compatible Approaches: Risk Measures, but Not Discounting Measures are Correlated

Zih-Yun Yan¹, Paul Glimcher¹
¹New York University

P1-E-15 Retrospective bias in goal pursuit

Sneha Aenugu¹, John O'Doherty¹
¹California Institute of Technology

P1-E-16 Pain now! Exploring the relationship between pain, temporal uncertainty, and inter-temporal choices

Mathieu Roy¹, Taryn Berman¹
¹McGill University

P1-E-17 - "Will" it be Seen? Using Eye Tracking to Re-examine the Future Tense Effect in Intertemporal Choices

Josie Chen¹, Wei Chen¹, Jiang-Shiang Hu¹
¹National Taiwan University

P1-E-18 Understanding the mechanism of perceived control: the role of self-efficacy and response-efficacy

Yun-Yen Yang¹, Mauricio Delgado¹
¹Rutgers University - Newark

P1-F-19 Effects of social vs. non-social stimuli on threat learning in Pavlovian-to-instrumental transfer

Nidhi Desai¹, Sophie Paolizzi¹, Michael Hallquist¹
¹University of North Carolina, Chapel Hill

P1-F-20 The Influence of Vasopressin Deficiency on Social Decision-Making in CDI Patients

Mikhail Votinov¹
¹Research Center Jülich

P1-F-21 Effort Allocation in Competition and Cooperation

Nicholas Angelides¹, Michael Platt¹
¹University of Pennsylvania

P1-F-22 Linking Brain-Wide Activity Patterns during Neuroeconomic Decision Making to Aggression

Romain Durand-De Cuttoli¹, Brian Sweis¹, Antonio Aubry¹, Long Li¹, Eric Nestler¹, Scott Russo¹
¹Icahn School of Medicine

P1-F-23 Friends diverge while strangers align: Using fMRI hyperscanning to investigate social interaction in real-time conversations

Sebastian Speer¹, Emily Falk², Laëtita Mwilambwe-Tshilobo³, Diana Tamir¹, Shannon Burns⁴, Lily Tsoi⁵
¹Princeton University, ²University of Pennsylvania, ³Princeton University & University of Pennsylvania, ⁴Pomona College, ⁵Caldwell University

P1-G-24 Delay discounting and risk tolerance in obsessive-compulsive disorder: results from the Global OCD study

Karolina Lempert¹, Benjamin Huber², Marcelo Batistuzzo³, Kartik Sheshachala⁴, Dianne Hezel², Niels De Jooze⁵, Clara Marincowitz⁶, Christine Lochner⁶, Dan Stein⁷, Janardhanan Narayanaswamy⁴, Odile Van Den Heuvel⁵, Melanie Wall², H. Blair Simpson²
¹Adelphi University, ²Columbia University, ³Universidade de São Paulo, ⁴National Institute of Mental Health and Neurosciences, ⁵Vrije Universiteit Amsterdam, ⁶Stellenbosch University, ⁷University of Cape Town

P1-G-25 The "motive cocktail" in third-party punishment and helping

Xiaoyan Wu¹, Xiangjuan Ren², Chao Liu¹, Hang Zhang²
¹Beijing Normal University, ²Peking University

P1-G-26 Examining the associations between socioeconomic status and temporal discounting across monetary, social, and health rewards

Christian Benitez¹, Michelle Mahecha Perez¹, Joe Kable¹
¹University of Pennsylvania

P1-G-27 Quantifying a task-invariant Bayesian prior for active avoidance: A pilot study

Tobias Granwald¹, Peter Dayan², Máté Lengyel³, Marc Guitart Masip¹
¹Karolinska Institutet, ²Max Planck Institute for Biological Cybernetics & University of Tübingen, ³University of Cambridge & Central European University

P1-H-28 Context-dependent P2 plasticity dynamics in the monetary incentive delay task

Anastasia Grigoreva¹, Alla Kondratenko¹, Aleksei Gorin¹
¹HSE University

P1-H-29 Accounting for Multiscale Processing in Adaptive Real-World Decision-Making via the Hippocampus

Dhruv Mehrotra¹, Laurette Dube², Goktug Bender²
¹Integrated Program in Neuroscience, McGill University, Canada, ²McGill University

P1-H-30 Reward-Driven Superstitions in Uncontrollable Environments

Haoyang Lu¹, Tianyuan Teng¹, Hang Zhang¹
¹Peking University

P1-H-31 Ambiguity and confirmation bias in reward learning

Hayley Dorfman¹, Rahul Bhui²
¹Harvard University, ²Massachusetts Institute of Technology

P1-H-32 Computational mechanisms underlying latent value updating of unchosen actions

Ido Ben-Artzi¹, Yoav Kessler², Bruno Nicenboim³, Nitzan Shahar¹
¹Tel Aviv University, ²Ben Gurion University of the Negev, ³Tilburg University

P1-I-33 Neural representation overlap predicts the decoy attraction effect

Asaf Madar¹, Ido Tavor¹, Dino Levy¹
¹Tel Aviv University

P1-I-34 Improvements in a Decision Support System from the evaluation of cognitive responses with EEG and Eye-Tracking

Anderson Lucas Carneiro De Lima Da Silva¹, Jefferson Souza Medeiros¹, Rayara Sirlei Mauricio De Oliveira¹, André Marques Cavalcanti¹, Ana Paula Costa¹, Lucia Reis Peixoto Roselli², Danielle Morais¹, Adiel de Almeida¹
¹Universidade Federal de Pernambuco, ²Federal University of Pernambuco

P1-I-35 Decomposing the mechanisms and timing of context effects

Liz Izakson¹, Minhee Yoo², Adam Hakim¹, Ian Krajbich³, Ryan Webb⁴, Dino Levy¹
¹Tel Aviv University, ²Ohio State University, ³University of California, Los Angeles, ⁴University of Toronto

P1-I-36 Disentangling forms of exploration in a multi-armed bandit task

Nick Sidorenko¹, Hui-Kuan Chung¹, Boris Quednow², Helen Hayward-Könnecke³, Alexander Jetter³, Philippe Tobler¹
¹University of Zürich, ²Psychiatric University Hospital Zurich, ³University Hospital Zurich

P1-K-37 The association between gaze and choice in value-based decisions may arise post hoc—that is, after the decision

Ariel Zylberberg¹, Michael Shadlen¹
¹Columbia University

P1-K-38 Effects of encoding precision and comparison difficulty on attentional discounting

Da Li¹, Todd Hare¹
¹University of Zürich

P1-K-39 EEG neural correlates of regret and rejoicing: a neuroeconomic experiment

Łukasz Tanajewski¹, Illia Kuznietsov², Marcin Furtak³, Oleksandr Zhuravlov⁴, Martin Schürmann⁵
¹Kozminski University, ²Faculty of Medicine and Biology, Lesya Ukrainka Volyn National University, Lutsk, Ukraine, ³Nencki Institute of Experimental Biology, ⁴Faculty of Medicine and Biology, Lesya Ukrainka Volyn National University, Lutsk, Ukraine, ⁵University of Nottingham

P1-K-40 The Role of Information Availability in Simple Decisions

Douglas Lee¹, Kostantinos Tsetsos², Giovanni Pezzulo³, Nitzan Shahar¹, Marius Usher¹
¹Tel Aviv University, ²University of Bristol, ³National Research Council of Italy

P1-K-41 - Attentional mechanisms underlying cooperative behavior

Claire Lugin¹, Arkady Konovalov², Christian Ruff¹
¹University of Zürich, ²University of Birmingham

P1-L-42 Good (enough) practices for reproducible neuroeconomics and decision neuroscience research

Ana Martinovici¹
¹Erasmus University

P1-L-43 When lie-detectors go overboard: preventing the neural predictor of deception from predicting honest selfishness

Sangil Lee¹, Runxuan Niu², Lusha Zhu², Andrew Kayser³, Ming Hsu¹
¹University of California, Berkeley, ²Peking University, ³University of California, San Francisco

P1-L-44 Neurally Revealed Preference and Beliefs over Resolving Uncertainty

Stefan Bucher¹, Zih-Yun Yan², Paul Glimcher², Peter Dayan¹
¹Max Planck Institute for Biological Cybernetics & University of Tübingen, ²New York University

Poster Session 2

SATURDAY, OCTOBER 14

P2-B-1 Can Responsiveness to Marketing-Induced Calorie Estimation Errors be Linked to Individual Differences in Metabolic Health?

Shemal Doshi¹
¹INSEAD Business School

P2-B-2 Throwing good effort after bad: Evidence for a sunk-cost effect in cognitive effort-based decision-making

Ziqi Fu¹, Sean Devine¹, Mario Bogdanov^{1,2,3}, Yiguo Wang¹, A. Ross Otto¹
¹McGill University, ²Harvard University, ³McLean Hospital

P2-B-3 Body mass index-dependent shifts along large-scale gradients in human cortical organization explain dietary regulatory success

Rémi Janet¹, Jonathan Smallwood², Cendri Hutcherson³, Hilke Plassmann⁴, Bronte Mckeown², Anita Tusche¹
¹Queen's University, ²Department of Psychology, ³University of Toronto, ⁴INSEAD Business School

P2-B-4 Contributions of General Causality Orientations to Competitive and Cooperative Effort-Based Decision Making

Nicholas Angelides¹, Michael Platt¹
¹University of Pennsylvania

P2-B-5 Decision-making on food consumption: A fNIRS study

Victoria Moiseeva¹, Mario Martinez-Saito², Ksenia Panidi¹, Vladimir Kosonogov², Anna Shestakova²
¹Higher School of Economics, ²HSE University

P2-B-6 Metacognitive Monitoring Compensates for Memory Limitations in Open-Ended Decisions

Zhihao Zhang¹, Andrew Kayser², Ming Hsu³
¹University of Virginia, ²University of California, San Francisco, ³University of California, Berkeley

P2-D-7 Computational modeling of a novel choice rodent gambling task.

Claire Hales¹, Kelly Hrelja¹, Catharine Winstanley¹
¹University of British Columbia

P2-D-9 The Effect of Acute Stress on Humanitarian Supplies Management.

Maximilian Burkhardt¹, Felix Nitsch², Stefan Spinler¹, Luk Van Wassenhove²
¹WHU Otto Beisheim School of Management, ²INSEAD Business School

P2-D-10 Trial-to-trial fluctuations in risk preference originate from Bayesian inference on noisy neural representations

Gilles De Hollander¹, Marcus Grueschow¹, Christian Ruff¹
¹University of Zürich

P2-D-11 The Processing of Negative Numbers and its Impact on Subjective Valuation

Hannah Seidler¹, Sebastian Olschewski², Benjamin Scheibehenne¹
¹Karlsruhe Institute of Technology, ²University of Basel & Warwick Business School

P2-E-12 Internal brain activity and decision making: the effect of pre-stimulus midbrain activity fluctuations on self-control

Jakub Skalbani¹, Łukasz Tanajewski², Marcin Furtak³, Marek Wypych³
¹Kozminski University, ²Kozminski University, ³Nencki Institute of Experimental Biology

P2-E-13 Behavioral evidence for flexible recency-dependent valuation

Yixin Chen¹, Yutong Li¹, Yeshim Onipede¹, Joseph McGuire¹
¹Boston University

P2-E-14 Dissociable sensitivity to effort and delay costs underlies apathy and impulsivity in Huntington's disease

Lee-Anne Morris¹, Kyla-Louise Horne², Laura Paermentier², Christina Buchanan³, Michael Macaskill², Daniel Myall², Sanjay Manohar⁴, Matthew Apps⁵, Masud Husain⁴, Richard Roxburgh⁶, Tim Anderson², Campbell Le Heron²
¹University of Otago, Christchurch, ²New Zealand Brain Research Institute, ³Auckland City Hospital, ⁴University of Oxford, ⁵University of Birmingham, ⁶University of Auckland

P2-E-15 Validating a behavioral measure of individual differences in willingness to wait for delayed rewards

Lena Schaefer¹, Yixin Chen¹, Daniel Fulford¹, Joseph McGuire¹
¹Boston University

P2-F-16 The computational basis of private and social information aggregation in social networks

Wenning Deng¹, Antonio Rangel¹
¹California Institute of Technology

P2-F-17 Does Androstadienone Affect Social Distance-Dependent Prosocial Behavior? A Double-blind, Placebo-controlled Study

Junsong Lu¹, Yin Wu¹
¹The Hong Kong Polytechnic University

P2-F-18 Psychopharmacology of Social Reward Revaluation

Tobias Kalenscher¹, Sandra Schöble¹, Irina Noguier-Calabús¹
¹Heinrich Heine University Düsseldorf

P2-F-19 - Loss framing increases sensitivity to productivity and luck in distributive decision

Yoonseo Zoh¹, Ryan Carlson², Steve Chang², Molly Crockett¹, Yeon Soon Shin¹
¹Princeton University, ²Yale University

P2-F-20 - Children's Subjective Socioeconomic Status and its Effect on Sharing Behavior in an Online Dictator Game

Sylvia Pinheiro¹, Lisa Bas¹, Anita Tusche¹, Valerie Kuhlmeier¹
¹Queen's University

P2-G-21 Exploration in decision-making under uncertainty may be regulated by learning, not by offline tDCS

Victor Timokhov¹, Oksana Zinchenko¹, Anna Shestakova¹, Victoria Moiseeva², Vasily Kliucharev³
¹HSE University, ²Higher School of Economics, ³Higher School of Economics - National Research University

P2-G-22 Cognitive Components of Trust

Xiaoyan Wu¹, Niklas Bürgi², Christian Ruff³
¹Beijing Normal University, ²University of Zurich, ³University of Zürich

P2-H-23 How to behave variable: meta-learning learning rate or meta-learning epsilon?

Janne Reynnders¹, Tom Verguts¹, Senne Braem¹
¹Ghent University

P2-H-24 Learning non-linear rewarding rules can be difficult, even in a minimalistic environment

Jianbo Chen¹, Tianyuan Teng¹, Hang Zhang¹
¹Peking University

P2-H-25 Separable neurocomputational mechanisms underlying multisensory learning

Saurabh Bedi¹, Ella Casimiro¹, Gilles De Hollander¹, Arkady Kononov², Fritjof Helmchen¹, Silvia Brem¹, Christian Ruff¹
¹University of Zürich, ²University of Birmingham

P2-H-26 The impact of presentation order and response labeling on the reward learning of task representations

Mina Habibi¹, Mehdi Senoussi², Pieter Verbeke¹, Senne Braem¹
¹Ghent University, ²Université de Toulouse

P2-I-27 System neglect is associated with network-level parameter selectivity

Mu-Chen Wang¹, George Wu, Shih-Wei Wu¹
¹National Yang Ming Chiao Tung University

P2-I-28 Characterizing the causes, dynamics, and consequences of choice deferral

Yi-Hsin Su¹, Xiamin Leng¹, Amitai Shenhav¹
¹Brown University

P2-I-29 A Bayesian noisy-memory account of recency effects in averaging tasks

Arthur Prat-Carrabin¹, Michael Woodford¹
¹Columbia University

P2-I-30 Different sources of cognitive noise explain distinct and opposing contextual modulation effects in value-based decision-making

Bo Shen¹
¹New York University

P2-I-31 Context effects in multi-attribute choice

Giulia Mezzadri¹, Michael Woodford¹
¹Columbia University

P2-I-32 Does affect bias investment decisions among professional investors?

Jennifer Eberhardt¹, Hazel Markus¹, Brian Knutson¹, Golijeh Golarai¹
¹Stanford University

P2-I-33 When models matter: How we learn to arbitrate between model-based and model-free reward learning

Leslie Held¹, Wouter Kool², Senne Braem¹
¹Ghent University, ²Washington University

P2-I-34 Individual differences in effort-based decision-making: dorsomedial prefrontal cortex metabolic and fMRI underpinnings

Nicolas Clairis¹, Arthur Barakat¹, Carmen Sandi¹
¹Behavioral Genetics Laboratory (LGC)

P2-K-35 Altruism and attention to social information

Miruna Cotet¹, Mariana Blanco², Ian Krajbich^{1,3}
¹Ohio State University, ²Universidad del Rosario, ³University of California, Los Angeles

P2-K-36 Segmenting Experience into Generalizable Predictive Knowledge

Euan Prentis¹, Akram Bakkour¹
¹University of Chicago

P2-K-37 Supernormal Stimuli and the Peak-Shift Effect in Humans

Filip-Mihai Toma¹, Zhenlin Kang¹, Sarah Tashjian¹, Shinsuke Shimojo¹, Dean Mobbs¹, Colin Camerer¹
¹California Institute of Technology

P2-K-38 Cognitive and neural bases of salience-driven incidental learning

Sai Sun¹, Hongbo Yu², Shuo Wang³, Rongjun Yu⁴
¹Tohoku University, ²University of California, Santa Barbara, ³Washington University in St. Louis, ⁴Hong Kong Baptist University

P2-K-39 Brain network signature of attention during cue-approach training predicts change in food preferences

Xinyue Li, Ziwei Zhang¹, Monica Rosenberg¹, Akram Bakkour¹
¹University of Chicago

P2-K-40 Differential effects of prior outcomes and pauses on the speed and quality of risky choices

Zhang Chen¹, Charlotte Eben¹, Frederick Verbruggen¹

¹Ghent University

P2-L-41 Neurocomputational mechanisms of sensory plasticity associated with the one-armed bandit task

Anush Ghambaryan¹, Anastasia Grigoreva², Anna Shestakova², Victoria Moiseeva³

¹HSE University & École normale supérieure, ²HSE University,

³Higher School of Economics

P2-L-42 Neuroeconomic data for the calibration of disequilibrating excessive demand in economics and finance models

John Haracz¹, Mehreen Zakaria²

¹Indiana University, ²Columbia University

P2-L-43 The interplay of hedonic appetite and attentional abilities is linked to poorer dietary self-control

Łukasz Tanajewski¹, Todd Hare², Jakub Skalbani³

¹Kozminski University, ²University of Zürich, ³Kozminski University

P2-L-44 Disentangling the affective impact of stimulus proximity and motion using immersive virtual reality

Tara Srirangarajan¹, Yan Yan¹, Jeremy Bailenson¹, Brian Knutson¹

¹Stanford University

Poster Session 3

SUNDAY, OCTOBER 15

P3-C-1 Inferring latent social network properties aids strategic gossip-sharing

Alice Xia¹, Apoorva Bhandari¹, Oriel FeldmanHall¹

¹Brown University

P3-C-2 Diversity Matters: An Agent-Based Simulation Approach on Group Cooperation and Performance

Chris Stolle¹, Bartosz Gula², Yi Huang¹

¹Lingnan University, ²University of Klagenfurt

P3-C-3 Aligning of minds: Shared neural codes predict online coordination

Cong Wang¹, Lusha Zhu¹

¹Peking University

P3-C-4 Neural and behavioral dynamics of reciprocal sibling interaction in the Taylor Aggression Paradigm

Julia Koch¹, Lucia Hernandez Pena, Rik Sijben, Edward S. Brodtkin, Ute Habel², Lisa Wagens²

¹University Hospital & RWTH Aachen University, ²Medical Faculty, Uniklinik RWTH Aachen

P3-C-5 Stereotypic expectations entrench unequal conventions across generations in deep multi-agent reinforcement learning

Rebekah Gelpi¹, Yikai Tang¹, Ethan Jackson, William Cunningham¹

¹University of Toronto

P3-D-6 Bidding with Effort: Using Grip Force to Assess the Value of Information

Haixue Fan¹, Bryan Dong¹, Dorothy Benkelman¹, Alexandra Rodman², Hayley Dorfman¹, Paul Glimcher³, Elizabeth Phelps¹

¹Harvard University, ²Northeastern University, ³New York University

P3-D-7 Role of Phasic Mesocorticolimbic Dopamine Release in Risk/Reward Decision Making

Jackson Schumacher¹, Mudi Zhao¹, Debra Bercovici¹, Melody Hall¹, Stan Floresco¹

¹University of British Columbia

P3-D-8 Computational Contributions to Prosocial and Utilitarian Risk-taking

Jiajin Zhang¹, Sarah Tashjian¹, Alma Merscher², Dean Mobbs¹

¹California Institute of Technology, ²University of Würzburg

P3-D-9 Volatile stocks cause higher inter-subject correlation in the right anterior insular cortex

Kirill Efimov¹, Ksenia Panidi², Victoria Moiseeva², Anna Shestakova¹, Iiro Jääskeläinen¹, Vasiliy Kliucharev³

¹HSE University, ²Higher School of Economics, ³Higher School of Economics - National Research University

P3-E-11 Rational decision making for distant goals

Shiyi Liang¹, Evan Russek², Robb Rutledge³, Elliott Wimmer¹

¹University College London, ²Princeton University, ³Yale University

P3-E-12 Association between brain structure and genetic predisposition for high impulsivity in children.

Mari Shishikura¹, Filip Morys¹, Alain Dagher¹

¹McGill University

P3-E-13 Not all discounts are created equal: regional activity and brain networks in temporal and effort discounting

Mohith Varma¹, Shanshan Zhen², Rongjun Yu¹

¹Hong Kong Baptist University, ²City University of Hong Kong

P3-E-14 The interplay between stress, imagining the future, and intertemporal choice

Seoyoung Lee¹, Anita Restrepo¹, Hayoung Ahn¹, Greg Norman¹, Akram Bakkour¹

¹University of Chicago

P3-F-15 Information Seeking in Social Decision-Making is Driven by Instrumental Benefit

Alexandra Ramirez¹, Kenji Kobayashi¹, Joe Kable¹

¹University of Pennsylvania

P3-F-16 Social construction of value explains partisan alignment in behavior and neural representation

Benjamin Lu¹, Bo Shen¹, Jay Van Bavel¹, Paul Glimcher¹

¹New York University

P3-F-17 Reduced confidence in situations of observational learning

David Aguilar-Lleyda¹, Wojciech Zajkowski², Rei Akaishi¹

¹RIKEN Institute, ²RIKEN Center for Brain Science

P3-F-18 Verbal information exchange enhances collective performance through increasing group identification

Enhui Xie

P3-F-19 Network position biases mental representations of real-world social networks

Isabella Aslarus¹, Oriel Feldmanhall¹

¹Brown University

P3-H-20 Meta-learning environment-specific learning rates

Jonas Simoons¹, Tom Verguts¹, Senne Braem¹

¹Ghent University

P3-H-21 - How the statistical information of others' donation influences individual donation behavior

Tao Jin¹, Iris M Vilares²

¹University of Minnesota, ²University of Minnesota, Twin Cities

P3-H-22 Forget and Forgive: a Memory-Based Mechanism for Increased Cooperation During Dynamic Group Formation

Wojciech Zajkowski¹, Ryan Badman², Masahiko Haruno³, Rei Akaishi⁴

¹RIKEN Center for Brain Science, ²Icahn School of Medicine, ³Center for Information and Neural Networks, ⁴RIKEN Institute

P3-I-24 Neural representations of attribute-based valuation across contexts.

Aniek Fransen¹, Kiyohito Iigaya², John O'Doherty¹

¹California Institute of Technology, ²Columbia University

P3-I-25 Memorability biases early memory sampling during risky choice

Hyuna Cho¹, Cendri Hutcherson¹

¹University of Toronto

P3-I-26 Medial prefrontal-amygdala circuits contribute to cue-guided probabilistic reward decision-making in rats

Mudi Zhao¹, Shrishti Ramaiah¹, Stan Floresco¹

¹University of British Columbia

P3-I-27 Specialized Neuronal Module in the Orbitofrontal Cortex for Economic Choice

Chengze Xu¹, Kuntan Ni¹, Xinying Cai¹

¹New York University Shanghai

P3-I-28 Transfer in searching for problem solutions: insights from a visual puzzle game

Yang-Fan Lu¹, Hang Zhang¹

¹Peking University

P3-I-29 Diabetes alters economically dissociable decision-making algorithms depending on the salience of reward scarcity in the environment

Chinonso Nwakama¹, Romain Durand-De Cuttoli², Zainab Oketokoun³, Samantha Brown³, Jillian Haller⁴, Adriana Méndez³, Mohammad Jodeiri Farshbaf³, Y. Zoe Cho⁵, Sanjana Ahmed⁶, Jessica Ables³, Brian Sweis²

¹University of Minnesota, Mount Sinai, ²Icahn School of Medicine,

³Mount Sinai, ⁴University of Scranton, Mount Sinai, ⁵Barnard College & Mount Sinai, ⁶Macaulay Honors College

P3-I-30 Does affect bias investment decisions among professional investors?

Golijeh Golarai¹, Jennifer Eberhardt¹, Hazel Markus¹, Brian Knutson¹

¹Stanford University

P3-I-31 A neuro-temporal decoding investigation of multi-attribute decision making

Matthew Bachman¹, Azadeh HajiHosseini¹, Sophie Faessen¹, Cendri Hutcherson¹

¹University of Toronto

P3-I-32 Redefining Attribute Weighting in Food and Social Choices: Evidence for Non-linear Models

Dongqi (Sherry) Bao¹, Gaia Lombardi¹, Da Li¹, Carolina Feher Da Silva², Todd Hare¹

¹University of Zürich, ²University of Surrey

P3-I-33 Competition between stimulus- and action-based learning strategies accounts for monkeys' behavior during dynamic learning

Jae Hyung Woo¹, Kathryn Rothenhoefer², Ken-Ichiro Tsutsui³, Fabian Grabenhorst⁴, Vincent Costa², Wolfram Schultz⁵, Alireza Soltani¹

¹Dartmouth College, ²Oregon Health & Science University,

³Tohoku University, ⁴University of Oxford, ⁵University of Cambridge

P3-J-35 Identifying individual differences in (un)conscious emotion processing and decision-making via hierarchical drift diffusion models

Julia Schröder¹, Ute Habel², Han-Gue Jo³, Lennard Herzberg², Marie Kranz², Franziska Walter², Lisa Wagens²

¹RWTH Aachen University, ²Medical Faculty, Uniklinik RWTH Aachen, ³Kunsan National University

P3-J-36 Conceptual representations of emotions predict prosocial behavior

Marc-Lluis Vives¹, Joseph Heffner², Oriel Feldmanhall²

¹Leiden University, ²Brown University

P3-J-37 Pupillary dilation predicts self-reported arousal during monetary incentive anticipation and outcomes

Yan Yan¹, Tara Srirangarajan¹, Brian Knutson¹

¹Stanford University

P3-J-38 Negative affect and the computations underlying food choice in bulimia nervosa

Blair Shevlin¹, Loren Gianini², Joanna Steinglass², Karin Foerde², Caitlin Lloyd², Laura Berner¹

¹Icahn School of Medicine, ²Columbia University

P3-J-39 Shared neural representations and temporal segmentation of political content predict ideological similarity

Daantje De Bruin¹, Jeroen van Baar¹, Oriel Feldmanhall¹

¹Brown University

P3-J-40 Social Decision Making: How stereotypes and group membership interact to affect fairness, a fMRI study

Harshil Vyas¹, Paloma Diaz-Gutierrez², Carolyn Declerck¹, Christophe Boone¹

¹University of Antwerp, ²Universiteit Antwerpen

P3-J-41 Contributions of insula and superior temporal sulcus to interpersonal guilt in social decisions

Maria Gädeke¹, Tom Willems², Omar Salah Ahmed¹,
Bernd Weber¹, René Hurlemann³, Johannes Schultz¹

¹University of Bonn, ²University of Bern, ³University of Oldenburg

P3-J-42 An Integrative Model of Information Sharing Decisions: Semantic features, neural correlates, and affective experience

Saskia Balny D'avricourt¹, Bruce Doré¹, Laurette Dube¹

¹McGill University

P3-L-43 How Working Memory Overload May Reduce Dietary Self-control: A Neuroeconomic Experiment

Łukasz Tanajewski¹, Jakub Skalbani², Marcin Furtak³,
Marek Wypych³, Todd Hare⁴

¹Kozminski University, ²Kozminski University, ³Nencki Institute of Experimental Biology, ⁴University of Zürich

P3-L-44 Effect of transcranial direct current stimulation (tDCS) on FRN and P2 during the performance of auditory monetary incentive delay task

Anastasia Grigoreva¹, Aleksei Gorin¹, Valeriy Klyuchnikov¹,
Anna Shestakova¹

¹HSE University

P3-L-45 Designing a sustainable economy with deep reinforcement learning

Raphael Koster¹

¹Google DeepMind

Poster Author Index

AUTHOR	POSTER NUMBERS
Abbott, Larry	O3.3
Ables, Jessica	P3-I-29
Aenugu, Sneha	P1-E-15
Aguilar-Lleyda, David	P3-F-17
Ahmed, Sanjana	P3-I-29
Ahn, Hayoung	P3-E-14
Akaishi, Rei	P3-F-17, P3-H-22
Anderson, Tim	P2-E-14
Angelides, Nicholas	P1-F-21, P2-B-4
Apps, Matthew	P2-E-14
Aslarus, Isabella	P3-F-19
Aubry, Antonio	P1-F-22
Axel, Richard	O3.3
Aydogan, Gökhan	P1-D-12
Bachman, Matthew	P3-I-31
Badman, Ryan	O3.3, P3-H-22
Bailenson, Jeremy	P2-L-44
Bakkour, Akram	P2-K-36, P2-K-39, P3-E-14
Balny D'avricourt, Saskia	P3-J-42
Bao, Dongqi (Sherry)	P3-I-32
Barakat, Arthur	P2-I-34
Bas, Lisa	O2.4, P2-F-20
Batistuzzo, Marcelo	P1-G-24
Bazzani, Andrea	P1-B-1
Bedi, Saurabh	P1-D-12, P2-H-25
Ben-Artzi, Ido	P1-H-32
Bender, Goktug	P1-H-29
Benedetti, Davide	P1-B-1
Benitez, Christian	P1-G-26
Benkelman, Dorothy	P3-D-6
Bercovici, Debra	P3-D-7
Berman, Taryn	P1-E-16
Berner, Laura	P3-J-38
Bhandari, Apoorva	P3-C-1
Bhui, Rahul	P1-H-31
Blanco, Mariana	P2-K-35
Blumwald, Jake	O1.3
Bogdanov, Mario	P2-B-2
Boksem, Maarten	O4.4
Boone, Christophe	O2.1, P3-J-40
Boorman, Erie	O1.3
Braem, Senne	P2-H-23, P2-H-26, P2-I-33, P3-H-20
Brandenburger, Adam	P1-C-6
Brem, Silvia	P2-H-25

AUTHOR	POSTER NO.
Brody, Carlos	S1.1
Bromberg-Martin, Ethan	O3.3, S1.2
Brown, Samantha	P3-I-29
Buchanan, Christina	P2-E-14
Bucher, Stefan	P1-L-44
Bürgi, Niklas	P2-G-22
Burkhardt, Maximilian	P2-D-9
Burns, Shannon	P1-F-23
Bussell, Jennifer	O3.3
Cai, Xinying	P3-I-27
Camerer, Colin	P2-K-37
Carlson, Ryan	P2-F-19
Carneiro De Lima Da Silva, Anderson Lucas	P1-I-34
Casimiro, Ella	P2-H-25
Chang, Steve	P2-F-19
Chen, Jianbo	P2-H-24
Chen, Josie	P1-E-17
Chen, Wei	P1-E-17
Chen, Yixin	P2-E-13, P2-E-15
Chen, Zhang	P2-K-40
Cho, Hyuna	P3-I-25
Cho, Y. Zoe	P3-I-29
Christiano, Dylan	P1-B-4
Chung, Dongil	O3.2
Chung, Hui-Kuan	P1-I-36
Clairis, Nicolas	P2-I-34
Costa, Vincent	P3-I-33
Cotet, Miruna	P2-K-35
Crockett, Molly	P2-F-19
Cunningham, William	P3-C-5
Dagher, Alain	P3-E-12
Davydova, Alina	O4.3
Dayan, Peter	P1-G-27, P1-L-44
de Almeida, Adiel	P1-I-34
De Bruin, Daantje	P3-J-39
De Hollander, Gilles	P1-D-12, P2-D-10, P2-H-25
De Joode, Niels	P1-G-24
Declerck, Carolyn	O2.1, P3-J-40
Delgado, Mauricio	P1-E-18
Dell'osso, Liliana	P1-B-1
Deng, Wenning	P2-F-16
Depasquale, Brian	S1.1
Desai, Nidhi	P1-F-19
Devine, Sean	P2-B-2

AUTHOR	POSTER NO.
Diaz-Gutierrez, Paloma	O2.1, P3-J-40
Domenech, Philippe	O1.3
Dong, Bryan	P3-D-6
Doré, Bruce	P3-J-42
Dorfman, Hayley	P1-H-31, P3-D-6
Doshi, Shemal	P2-B-1
Dube, Laurette	P1-H-29, P3-J-42
Durand-De Cuttoli, Romain	P1-F-22, P3-I-29
Eben, Charlotte	P2-K-40
Eberhardt, Jennifer	P2-I-32, P3-I-30
Efimov, Kirill	P3-D-9
Eum, Brenden	O1.1
Faessen, Sophie	P3-I-31
Falk, Emily	P1-F-23
Fan, Haoxue	P3-D-6
Faraguna, Ugo	P1-B-1
Fehr Da Silva, Carolina	P3-I-32
Feldmanhall, Oriel	P3-C-1, P3-F-19, P3-J-36, P3-J-39
Feng, Yang-Yang	S1.2
Fernandez, Kianté	P1-B-5
Floresco, Stan	P3-D-7, P3-I-26
Foerde, Karin	P3-J-38
Fransen, Aniek	P3-I-24
Fruento, Paolo	P1-B-1
Fu, Ziqi	P2-B-2
Fulford, Daniel	P2-E-15
Furtak, Marcin	P1-K-39, P2-E-12, P3-L-43
Gädeke, Maria	P3-J-41
Gelpi, Rebekah	P3-C-5
Ghambaryan, Anush	P2-L-41
Ghasemi, Elnaz	O3.4
Gianini, Loren	P3-J-38
Glimcher, Paul	O1.4, P1-C-6, P1-D-14, P1-L-44, P3-D-6, P3-F-16
Globig, Laura	S1.3
Golarai, Golijeh	P2-I-32, P3-I-30
Gonzalez, Stephen	O1.1
Gorin, Aleksei	P1-H-28, P3-L-44
Grabenhorst, Fabian	P3-I-33
Granwald, Tobias	P1-G-27
Grigoreva, Anastasia	P1-H-28, P2-L-41, P3-L-44
Grueschow, Marcus	P2-D-10

AUTHOR	POSTER NUMBERS
Guitart Masip, Marc	P1-G-27
Gula, Bartosz	P3-C-2
Gupta, Diksha	S1.1
Gur Arie, Inbal	P1-B-3
Habel, Ute	P3-C-4, P3-J-35
Habibi, Mina	P2-H-26
HajiHosseini, Azadeh	P3-I-31
Hakim, Adam	O1.2, P1-B-3, P1-I-35
Hakimi, Shabnam	P1-B-4
Hales, Claire	P2-D-7
Halko, Marja-Liisa	P1-D-11
Hall, Melody	P3-D-7
Haller, Jillian	P3-I-29
Hallquist, Michael	P1-F-19
Haracz, John	P2-L-42
Hare, Todd	P1-K-38, P2-L-43, P3-I-32, P3-L-43
Haruno, Masahiko	P3-H-22
Hayward-Könnecke, Helen	P1-I-36
Heffner, Joseph	P3-J-36
Held, Leslie	P2-I-33
Helmchen, Fritjof	P2-H-25
Hernandez Pena, Lucia	P3-C-4
Hertz, Uri	S2.1, S2.4
Herzberg, Lennard	P3-J-35
Hezel, Dianne	P1-G-24
Horne, Kyla-Louise	P2-E-14
Hrelja, Kelly	P2-D-7
Hsu, Ming	P1-L-43, P2-B-6
Hu, Jiang-Shiang	P1-E-17
Huang, Yi	P3-C-2
Huber, Benjamin	P1-G-24
Hurlemann, René	P3-J-41
Husain, Masud	P2-E-14
Hutcherson, Cendri	P2-B-3, P3-I-25, P3-I-31, S1.4
Hytönen, Kaisa	P1-D-11
Hyung Woo, Jae	P3-I-33
Iigaya, Kiyohito	P3-I-24
Izakson, Liz	P1-I-35
Jääskeläinen, Iiro	O4.3, P1-D-11, P3-D-9
Jackson, Ethan	P3-C-5
Janet, Rémi	P2-B-3
Janssen, Marco	S2.1, S2.2
Jetter, Alexander	P1-I-36
Ji Ma, Wei	O4.1
Jin, Tao	P3-H-21

AUTHOR	POSTER NUMBERS
Jo, Han-Gue	P3-J-35
Jodeiri Farshbaf, Mohammad	P3-I-29
Kable, Joe	P1-G-26, P3-F-15
Kalenscher, Tobias	P2-F-18
Kang, Zhenlin	P2-K-37
Karmarkar, Uma	P1-B-5
Kayser, Andrew	P1-L-43, P2-B-6
Kessler, Yoav	P1-H-32
Klenk, Matthew	P1-B-4
Kliucharev, Vasiliiy	O4.3, P2-G-21, P3-D-9
Klyuchnikov, Valeriy	P3-L-44
Knutson, Brian	O2.2, O3.4, P1-B-4, P2-I-32, P2-L-44, P3-I-30, P3-J-37
Kobayashi, Kenji	P3-F-15
Koch, Julia	P3-C-4
Kondratenko, Alla	P1-H-28
Konova, Anna	O1.4
Konovalov, Arkady	P1-K-41, P2-H-25
Kool, Wouter	P2-I-33
Kopec, Charles	S1.1
Kosonogov, Vladimir	O4.3, P2-B-5
Koster, Raphael	P3-L-45, S2.1
Krajbich, Ian	P1-B-5, P1-I-35, P2-K-35
Kranz, Marie	P3-J-35
Kuhlmeier, Valerie	P2-F-20
Kurtz-David, Vered	O1.2, P1-C-6
Kuznietsov, Illia	P1-K-39
Lahti, Tom	P1-D-11
Le Heron, Campbell	P2-E-14
Lee, Douglas	P1-K-40
Lee, Sangil	P1-L-43
Lee, Seoyoung	P3-E-14
Leibo, Joel	S2.1
Lempert, Karolina	P1-G-24
Leng, Xiamin	P2-I-28
Lengyel, Máté	P1-G-27
Leone, Lewis	O1.4
Levy, Dino	O1.2, P1-B-3, P1-I-33, P1-I-35
Li, Da	P1-K-38, P3-I-32
Li, Jian	O2.3
Li, Long	P1-F-22
Li, Xinyue	P2-K-39
Li, Yutong	P2-E-13
Liang, Shiyi	P3-E-11
Lieder, Falk	O4.1

AUTHOR	POSTER NUMBERS
Lin, Yijun	O4.1
Liu, Chao	P1-G-25
Liu, Wenda	P1-C-9
Lloyd, Caitlin	P3-J-38
Lochner, Christine	P1-G-24
Lombardi, Gaia	P3-I-32
Louie, Kenway	O3.1
Lu, Benjamin	P3-F-16
Lu, Haoyang	P1-H-30
Lu, Junsong	P2-F-17
Lu, Yang-Fan	P1-D-13, P3-I-28
Lu, Yilong	P1-D-13
Lugrin, Claire	P1-K-41
M Vilares, Iris	P1-C-7, P3-H-21
Macaskill, Michael	P2-E-14
Madar, Asaf	O1.2, P1-I-33
Mahecha Perez, Michelle	P1-G-26
Manohar, Sanjay	P2-E-14
Marincowitz, Clara	P1-G-24
Mark, Isabella	P1-C-9
Markus, Hazel	P2-I-32, P3-I-30
Marques Cavalcanti, André	P1-I-34
Martinez-Saito, Mario	P1-C-10, P2-B-5
Martinovici, Ana	P1-L-42
Mcguire, Joseph	P2-E-13, P2-E-15
Mckeown, Bronte	P2-B-3
Mehrotra , Dhruv	P1-H-29
Méndez, Adriana	P3-I-29
Merscher, Alma	P3-D-8
Mezzadri, Giulia	P2-I-31
Mirny, Daniel	P1-B-2
Mobbs, Dean	P2-K-37, P3-D-8
Moiseeva, Victoria	P2-B-5, P2-G-21, P2-L-41, P3-D-9
Monosov, Ilya	S1.2
Morais, Danielle	P1-I-34
Morris, Lee-Anne	P2-E-14
Mortazavi, Leili	O3.4
Morys, Filip	P3-E-12
Murakami, Kalani	P1-B-4
Mwilambwe-Tshilobo, Laëtitia	P1-F-23
Myall, Daniel	P2-E-14
Narayanaswamy, Janardhanan	P1-G-24
Nestler, Eric	P1-F-22
Ni, Kuntan	P3-I-27
Ni, Yinmei	O2.3
Nicenboim, Bruno	P1-H-32

AUTHOR	POSTER NUMBERS
Nitsch, Felix	O4.2, P2-D-9
Niu, Runxuan	P1-L-43
Noguer-Calabús, Irina	P2-F-18
Norman, Greg	P3-E-14
Ntoumanis, Ioannis	O4.3
Nwakama, Chinonso	P3-I-29
O'Doherty, John	P1-E-15, P3-I-24
Ogasawara, Takaya	S1.2
Oketokoun, Zainab	P3-I-29
Oliveira, Rayara Sirlei Mauricio De	P1-I-34
Olschewski, Sebastian	P2-D-11
Onipede, Yeshim	P2-E-13
Orloff, Mark	O1.3
Otto, A. Ross	P2-B-2
Paermentier, Laura	P2-E-14
Panidi, Ksenia	O4.3, P2-B-5, P3-D-9
Paolizzi, Sophie	P1-F-19
Parada, Valentina	P1-B-3
Park, Jiwon	O3.2
Park, Seongmin	O1.3
Paula Costa, Ana	P1-I-34
Pezzulo, Giovanni	P1-K-40
Phelps, Elizabeth	P3-D-6
Pinheiro, Sylvia	P2-F-20
Plassmann, Hilke	O4.2, P2-B-3
Platt, Michael	P1-F-21, P2-B-4
Prat-Carrabin, Arthur	P2-I-29
Prentis, Euan	P2-K-36
Punwani, Vivek	n/a
Quednow, Boris	P1-I-36
Raio, Candace	O1.4
Rajan, Kanaka	O3.3
Ramaiah, Shrishti	P3-I-26
Ramirez, Alexandra	P3-F-15
Rangel, Antonio	O1.1, P2-F-16
Reis Peixoto Roselli, Lucia	P1-I-34
Ren, Xiangjuan	P1-G-25
Renkert, Maike	P1-D-12
Restrepo, Anita	P3-E-14
Reynders, Janne	P2-H-23
Rodman, Alexandra	P3-D-6
Rosenberg, Monica	P2-K-39
Rosenblau, Gabriela	P1-C-9
Rothenhoefer, Kathryn	P3-I-33
Roxburgh, Richard	P2-E-14
Roy, Mathieu	P1-E-16

AUTHOR	POSTER NUMBERS
Ruff, Christian	P1-D-12, P1-K-41, P2-D-10, P2-G-22, P2-H-25
Russek, Evan	P3-E-11
Russo, Scott	P1-F-22
Rutledge, Robb	P3-E-11
S. Brodtkin, Edward	P3-C-4
Salah Ahmed, Omar	P3-J-41
Sandi, Carmen	P2-I-34
Schäble, Sandra	P2-F-18
Schaefer, Lena	P2-E-15
Scheibehenne, Benjamin	P2-D-11
Schröder, Julia	P3-J-35
Schultz, Johannes	P3-J-41
Schultz, Wolfram	P3-I-33
Schumacher, Jackson	P3-D-7
Schürmann, Martin	P1-D-11, P1-K-39
Seidler, Hannah	P2-D-11
Senoussi, Mehdi	P2-H-26
Shadlen, Michael	P1-K-37
Shahar, Nitzan	P1-H-32, P1-K-40
Sharot, Tali	S1.3
Shen, Bo	P2-I-30, P3-F-16
Shenhav, Amitai	P2-I-28
Sheronova, Yulia	O4.3
Sheshachala, Kartik	P1-G-24
Shestakova, Anna	O4.3, P2-B-5, P2-G-21, P2-L-41, P3-D-9, P3-L-44
Shevlin, Blair	P3-J-38
Shimojo, Shinsuke	P2-K-37
Shishikura, Mari	P3-E-12
Sidorenko, Nick	P1-I-36
Sijben, Rik	P3-C-4
Simoens, Jonas	P3-H-20
Simpson, H. Blair	P1-G-24
Skalbania, Jakub	P2-E-12, P2-L-43, P3-L-43
Smallwood, Jonathan	P2-B-3
Smidts, Ale	O4.4
Soltani, Alireza	P3-I-33
Soon Shin, Yeon	P2-F-19
Souza Medeiros, Jefferson	P1-I-34
Speer, Sebastian	P1-F-23
Spiller, Stephen	P1-B-2
Spinler, Stefan	P2-D-9
Srirangarajan, Tara	P1-B-4, P2-L-44, P3-J-37
Stein, Dan	P1-G-24
Steinglass, Joanna	P3-J-38

AUTHOR	POSTER NUMBERS
Stolle, Chris	P3-C-2
Su, Yi-Hsin	P2-I-28
Sun, Sai	P2-K-38
Sweis, Brian	P1-F-22, P3-I-29
Tamir, Diana	P1-F-23
Tanajewski, Łukasz	P1-K-39, P2-E-12, P2-L-43, P3-L-43
Tang, Yikai	P3-C-5
Tashjian, Sarah	P2-K-37, P3-D-8
Tavor, Ido	O1.2, P1-I-33
Teng, Tianyuan	P1-H-30, P2-H-24
Timokhov, Victor	P2-G-21
Tobler, Philippe	P1-I-36
Toma, Filip-Mihai	P2-K-37
Tsai, Jeanne	O2.2
Tsetsos, Kostantinos	P1-K-40
Tsoi, Lily	P1-F-23
Tsutsui, Ken-Ichiro	P3-I-33
Turchetti, Giuseppe	P1-B-1
Tusche, Anita	O2.4, P2-B-3, P2-F-20
Usher, Marius	P1-K-40
van Baar, Jeroen	P3-J-39
Van Bavel, Jay	P3-F-16
Van Brussel, Leo	O4.4
Van Den Heuvel, Odile	P1-G-24
Van Wassenhove, Luk	P2-D-9
Van, Monica	P1-B-4
Varma, Mohith	P3-E-13
Vélez, Natalia	S2.3
Verbeke, Pieter	P2-H-26
Verbruggen, Frederick	P2-K-40
Verguts, Tom	P2-H-23, P3-H-20
Vives, Marc-Lluis	P3-J-36
Votinov, Mikhail	P1-F-20
Vyas, Harshil	O2.1, P3-J-40
W. Korn, Christoph	P1-C-9
Wagels, Lisa	P3-C-4, P3-J-35
Wall, Melanie	P1-G-24
Walter, Franziska	P3-J-35
Wang, Cong	P3-C-3
Wang, Huan	O2.2
Wang, Mu-Chen	P2-I-27
Wang, Ruien	O2.4
Wang, Shuo	P2-K-38
Wang, Yiguo	P2-B-2
Webb, Ryan	P1-I-35
Weber, Bernd	P3-J-41
Wertenbroch, Klaus	O4.2
White, J. Kael	S1.2

AUTHOR	POSTER NUMBERS
Willems, Tom	P3-J-41
Wimmer, Elliott	P3-E-11
Wincent, Joakim	P1-D-11
Winstanley, Catharine	P2-D-7
Woodford, Michael	P2-I-29, P2-I-31
Wu, Charlene	O3.4, P1-B-4
Wu, George	P2-I-27
Wu, Shih-Wei	P2-I-27
Wu, Xiaoyan	P1-G-25, P2-G-22
Wu, Yin	P2-F-17
Wypych, Marek	P2-E-12, P3-L-43
Xia, Alice	P3-C-1
Xie, Enhui	P3-F-18
Xu, Chengze	P3-I-27
Xu, Yijun	O2.4

AUTHOR	POSTER NUMBERS
Yan, Yan	P2-L-44, P3-J-37
Yan, Zih-Yun	P1-D-14, P1-L-44
Yang Teoh, Yi	S1.4
Yang, Yun-Yen	P1-E-18
Yoo, Minhee	P1-I-35
Yu, Hongbo	P2-K-38
Yu, Rongjun	P1-C-10, P2-K-38, P3-E-13
Yue, Shulang	P1-C-7
Zajkowski, Wojciech	P3-F-17, P3-H-22
Zakaria, Mehreen	P2-L-42
Zha, Shuyi	P1-C-8
Zhang, Hang	P1-D-13, P1-G-25, P1-H-30, P2-H-24, P3-I-28

AUTHOR	POSTER NUMBERS
Zhang, Jiajin	P3-D-8
Zhang, Kaining	S1.2
Zhang, Peiyuan	O4.1
Zhang, Zhihao	P2-B-6
Zhang, Ziwei	P2-K-39
Zhao, Mudi	P3-D-7, P3-I-26
Zhen, Shanshan	P1-C-10, P3-E-13
Zhu, Lusha	P1-L-43, P3-C-3
Zhuravlov, Oleksandr	P1-K-39
Zinchenko, Oksana	P2-G-21
Zoh, Yoonseo	P2-F-19
Zylberberg, Ariel	P1-K-37



WE SPECIALIZE IN
Scientific, Academic & Research
Societies and their Conferences

Need help managing your Conference or Association?



CONFERENCE MANAGEMENT

From conception to delivery and post conference review, we are here to help you plan, prepare and deliver an outstanding conference.



ASSOCIATION MANAGEMENT

As a busy researcher and scientist, you've already got a lot on your plate without having to worry about managing your society. Step up and lead, knowing we can help.



CONFERENCE MANAGEMENT

Simplify your membership sign-ups, abstract submissions, conference registrations and exhibitor bookings with our payment processing enabled, integrated set of tools.



CONFERENCE MANAGEMENT

Let us help make you look great with a modern, interactive website for your Society or Conference.



Find out how we can help



office@podiumconferences.com

WWW.PODIUMCONFERENCES.COM



+1 800.472.7644



Sponsors

Platinum Sponsor

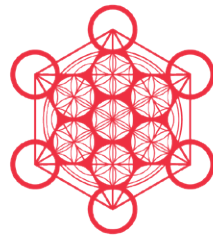

THE
KAVLI
FOUNDATION

Gold Sponsors



NYU

Institute for the Study
of Decision Making



THE UNIVERSITY OF
SYDNEY

Silver Sponsors

Caltech

T&C Chen Center for Social
and Decision Neuroscience



NEUROSCIENCE
Initiative

Bronze Sponsors



Centre for
Brain, Mind
and Markets



Rotman School of Management
UNIVERSITY OF TORONTO



University of
Zurich^{UZH}